



YOU WILL NEED:

Pegboards:

- Large square
- Small hexagon

Other:

- Twist ties: clear and black

Bead Colors:

- Peach - 20
- Magenta - 20
- Red - 37
- Rust - 42
- Crème - 10
- Yellow - 15
- Cheddar - 13
- Light Green - 15
- Kiwi Lime - 62
- Green - 42
- Dark Green - 42
- Toothpaste - 68
- Pastel Blue - 75
- Turquoise - 97
- Light Blue - 72
- Dark Blue - 33
- Pastel Lavender - 64
- Purple - 4
- Tan - 29
- Light Brown - 38
- Brown - 4
- Grey - 35
- Clear - 126
- White - 318
- Black - 74

Instructions

1. Place your beads on the pegboards as shown. If you are using a clear pegboard, slide the actual-size pattern underneath it.
2. Ask an adult to fuse your designs—see page 4 for further instructions.
3. Assembly: see page 3.

Bead Colors:

- Peach
- Rust
- Yellow
- Cheddar
- Light Green
- Green
- Dark Green
- Pastel Blue
- Light Blue
- Dark Blue
- Pastel Lavender
- Purple
- Tan
- Brown
- Grey
- Black
- White

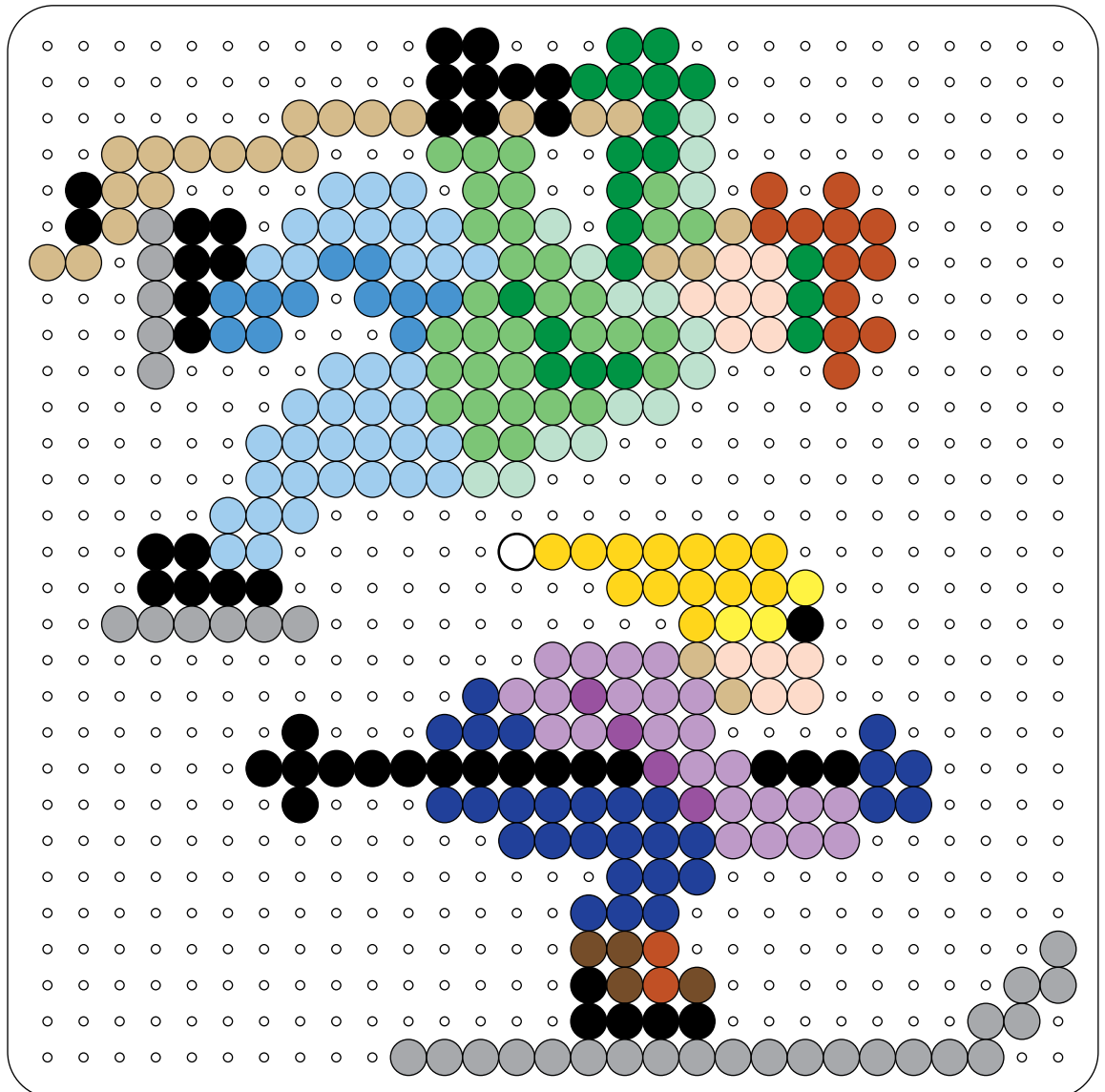

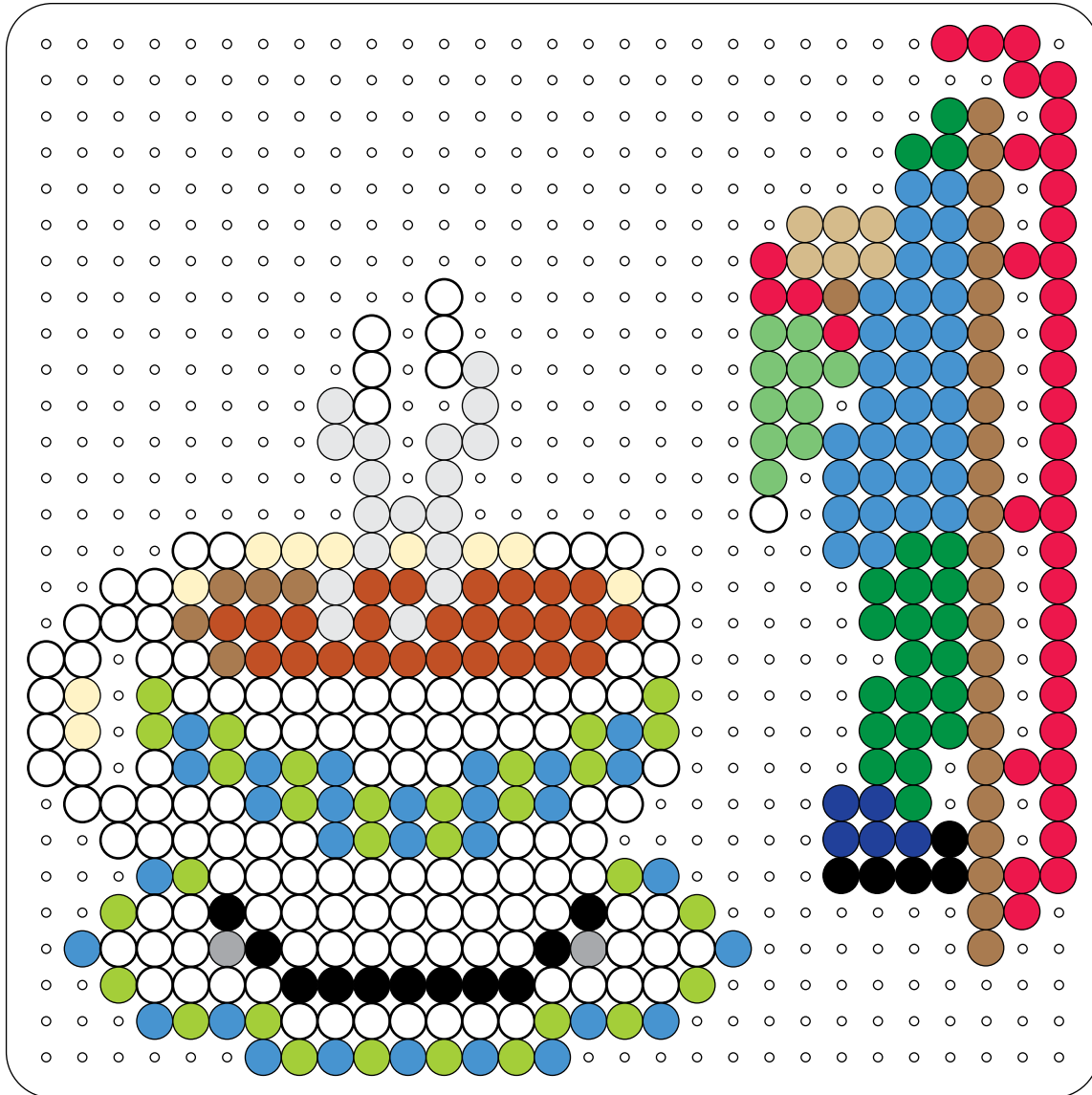

Bead Colors:

-  Red
-  Rust
-  Creme
-  Kiwi Lime
-  Green
-  Dark Green
-  Light Blue
-  Dark Blue
-  Tan
-  Light Brown
-  Clear
-  Grey
-  Black
-  White

Bead Colors:

- Peach
- Magenta
- Rust
- Yellow
- Kiwi Lime
- Pastel Blue
- Turquoise
- Pastel Lavender
- Light Brown
- Black
- White

To prepare for assembly of the 3-D skiers, set aside the following beads:

- 16 White
- 22 Pastel Lavender
- 22 Turquoise

Also, cut eight 4" lengths of clear twist tie for the arms and legs. Cut four 4" lengths of black twist tie for the ski poles.

ASSEMBLY

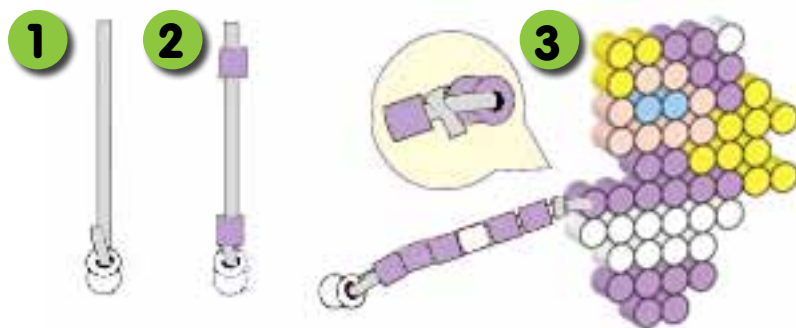

ARMS:

1. Thread 1 White bead on the end of a clear twist tie and secure the end. This is the hand.
2. Thread 3 colored beads (Pastel Lavender or Turquoise), then 1 White bead, then two more colored beads.
3. Insert the end of the twist tie into the shoulder bead and secure, trimming any excess.

LEGS:

Repeat the process, except start the twist tie by securing it in a ski. Thread 2 White beads, then 6 colored beads, finishing off at the torso.

SKI POLES: Insert one end of a black twist tie through the hand and draw through about 1". Insert the other end through the middle of a ski tip and draw through about 1/4".

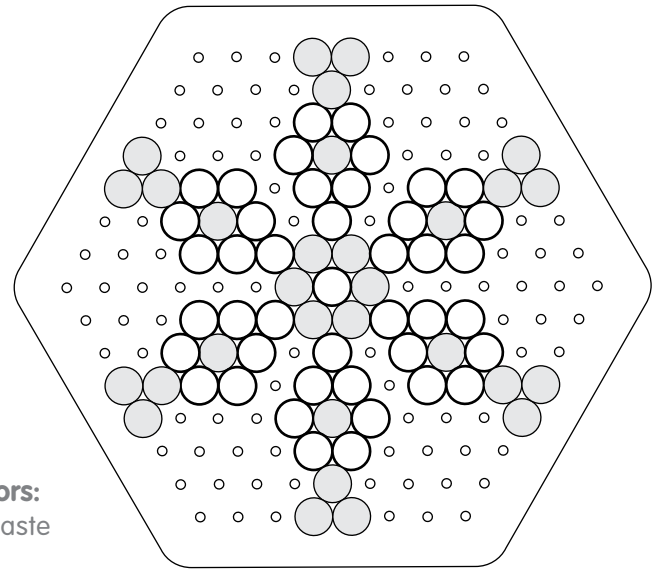
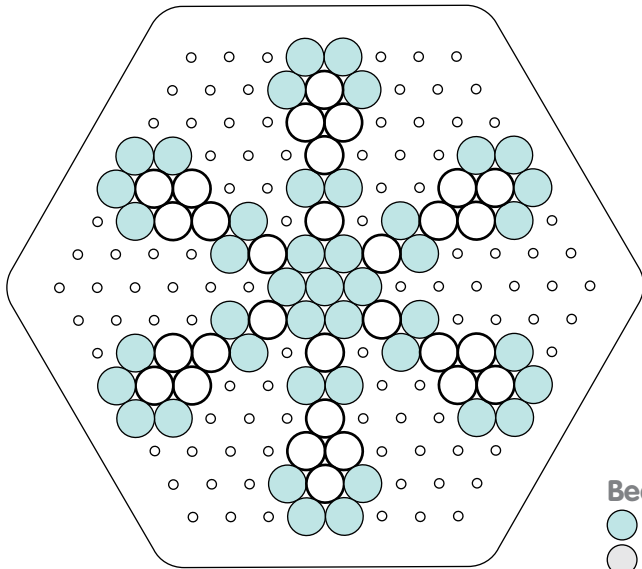

Bead Colors:
 ● Toothpaste
 ● Clear
 ● White

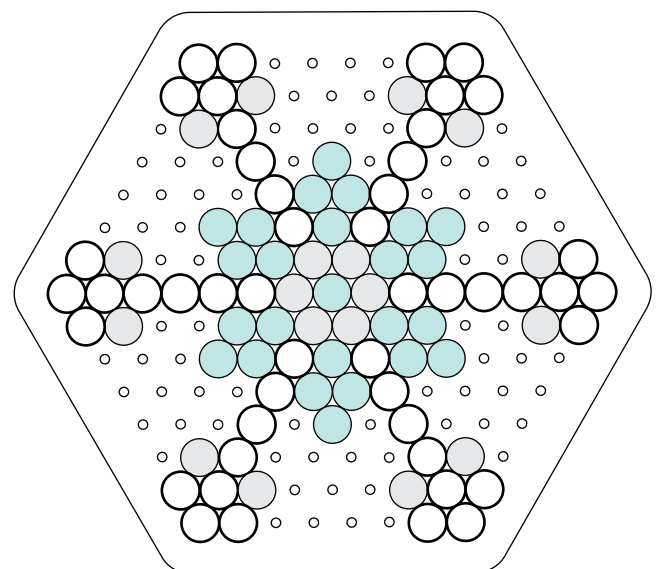
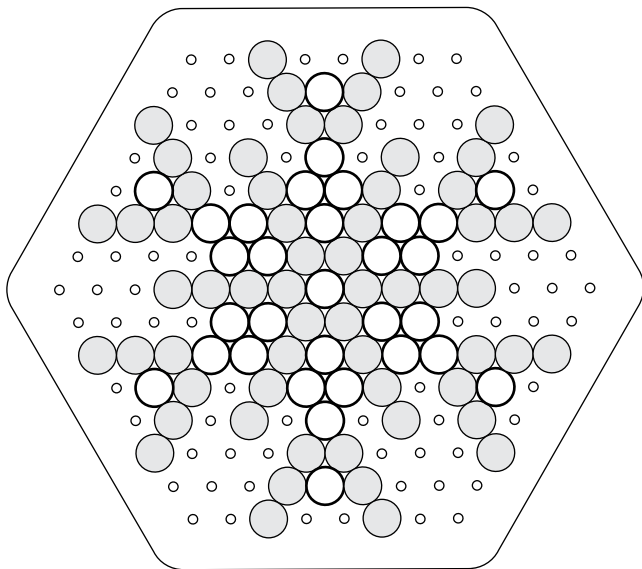

Fusing Instructions—Only Adults Iron



1. Place your pegboard on a flat, heat-safe surface.
2. Set a household iron to the medium setting. Place ironing paper over the pegboard. In a circular motion, begin to iron the project. Do not press down with the iron. As the beads begin to fuse, you will see circles of the beads start to show through the paper. When ironed properly, the beads will still have an open center. Let the design cool.
3. Remove the paper and bead design from the peg board. Flip the design over to expose the non-fused side. Repeat step two. Let cool completely.

NOTE: Beads need heat for about 10-20 seconds per side to fuse evenly. Lift the paper occasionally to see how the beads are fusing. Depending on the size of the project, additional heating time may be required. **DO NOT OVER-IRON** the beads as it will make the centers of the beads close and can make any assembly you do with your project more challenging.